

Thank you for using Kyla product! Please keep this Easy Start Guide for future use. For support or help, visit [kylaconnect.com](http://kylaconnect.com)

## DISCLAIMER

Aztech Technologies Pte Ltd, its holding company and its associated companies (hereinafter referred to collectively as "Aztech") does not guarantee that adequate warning or protection will be given, and disclaims all warranties and representations, whether expressed, implied or otherwise statutory, concerning the product, including without limitation any warranty of merchantability or fitness for a particular purpose. Aztech shall not be liable in any event for any consequential, indirect, incidental, special, exemplary, punitive or enhanced damages resulting from the use, maintenance or operation of the product.

The manufacturer makes no warranty or representation that the product is compliant with any requirements prescribed by any applicable state or laws, codes, regulations and/or other specifications that may be set out by relevant authorities having jurisdiction (collectively referred to as "regulations"). You shall be solely responsible for compliance with all regulations.

To the maximum extent permitted by applicable law, you agree to hold harmless and indemnify, including legal fees, the manufacturer and their personnel against any third party claims or fines by authorities that arise or are alleged to have arisen as a result of negligent or intentional act or omission by you or breach by you of any the terms herein or any violation of any regulations.

## UNPACKING

Perform the following steps to unpack the camera

1. Inspect the package to make sure that it has not been damaged. If damage item found, contact the local authorized Aztech Partner / Agent / Reseller.
2. Take all items out of the package and check whether any item is in defect condition. If you find damage item, contact the local authorized Aztech Partner / Agent / Reseller.

## PACKAGE CONTENTS

Dome Camera x1	User Manual x1	Warranty Card x1
Mounting Bracket x1	Plastic Anchors x2	Screws x2

## SAFETY INSTRUCTION

These instructions are intended to ensure that the user can use the camera correctly to avoid danger or property loss. Please read this Guide carefully before using the camera, and keep it properly for future reference. If the camera cannot work normally or is damaged because the user does not follow the safety instructions, we shall not assume any responsibility and warranty.

- Adopt power supply in the safety voltage range as per guidance.
- If camera does not work properly, please contact Aztech authorized partner / agent / dealer or the nearest service
- Do not drop the camera or subject it to physical shock / impact.

- When cleaning the lens, please use a rubber dust blower or lens cleaning cloth to remove the dirt. When cleaning transparent housing, please wipe gently by using soft and dry clean cloth. Never apply any cleanser with ethanol or benzene on it.
- Do not focus the camera lens on strong light such as the sun or incandescent lamp. The strong light can cause overexposure or glare (not camera malfunction), which may shorten camera lifetime.
- Do not expose the camera in the environment not defined in the Guide.

Operating Environment	
Working Voltage	PoE (IEEE 802.3af) 48-56V DC, 12V DC
Operating Temperature	-20°C ~ 50°C
Operating Humidity	≤ 95% RH (non-condensing)

- While shipping / transporting the camera, pack it in the factory packing or use materials with equivalent quality.
- When it is necessary to replace a part, please contact Aztech Authorized Partner / Agent / Dealer in advance and replace the part with specified model or part of the same model. We shall not assume any responsibility for problems caused by unauthorized replacement.
- The camera is for indoor purpose. Do not install at outdoor or anywhere the camera will be exposed to water.

## INITIAL CONFIGURATION

1. Connect ethernet cable from camera (12V DC power jack / Power Over Ethernet RJ45 jack) as alternative power source to camera.
2. Default camera's IP address is 192.168.1.100. Enter the camera's IP address in the address bar of your Chrome / Edge web browser, and then press Enter. User will be brought to Kyla IPC dashboard page and asked to create a new password. It is important to note that the camera has no default password. User will have to create a password access and use the camera. Password length minimum 8 characters and maximum 32 characters. The password must include uppercase, lowercase and numbers. Special character is accepted but not compulsory.
3. Upon successful in password creation, Log-in page will be automatically loaded.
4. Live view page will be automatically loaded upon successful log-in verification.
5. If live view page is not loaded, please clear browser's cache file and cookies before revisit the page.
6. Network Configuration:  
Recommended to set static IP for each camera.
  - Enterprise customer: It is recommended to consult with IT department to select available IP address, subnets mask, gateway and DNS address.
  - Residential customer: All this information can be found in internet router.

## NOTICE

The information in this document is subject to change without Note. Every effort has been made in the preparation of this document to ensure accuracy of the contents, but all statements, information, and recommendations in this document do not constitute a warranty of any kind, express or implied. Aztech is not responsible for printing or clerical errors.



Kyla

### CAMERA INSTALLATION

1. Screw the mounting bracket to the wall/ceiling

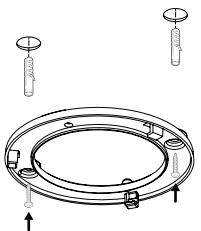

2. Insert the LAN cable and DC cable

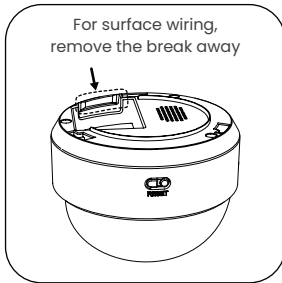
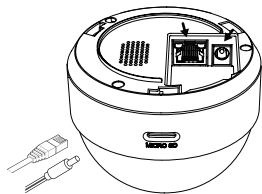

3. Rotate anti-clockwise to unlock the lens cover

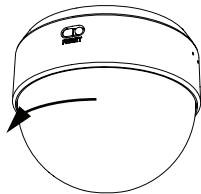

4. Plug the body to the bracket. Then rotate clockwise to lock it

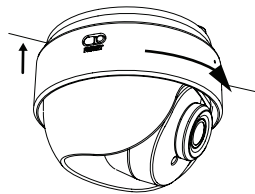

5. Adjust the camera angles

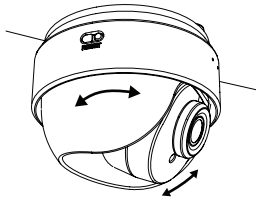

6. Rotate clockwise to lock the lens cover

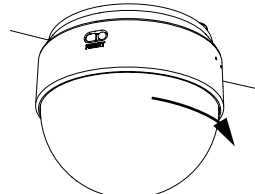

Kyla

### Dome Indoor IPC

User Manual

